

**This electronic collection of documents is provided  
for the convenience of the user  
and is Not a Certified Document –**

**The documents contained herein were originally issued  
and sealed by the individuals whose names and license  
numbers appear on each page, on the dates appearing  
with their signature on that page.**

**This file or an individual page  
shall not be considered a certified document.**

**STATE OF NORTH CAROLINA  
DIVISION OF HIGHWAYS**

<b>PROJ. REFERENCE NO.</b>	<b>SHEET NO.</b>
R-5207C	X-1A

Approximate quantities only. Borrow excavation, shoulder borrow, fine grading, clearing and grubbing, breaking of existing pavement, and removal of existing pavement will be paid for at the lump sum price for "Grading".

**NOTE: EMBANKMENT COLUMN DOES NOT INCLUDE BACKFILL FOR UNDERCUT**

**CROSS-SECTION SUMMARY**

Station	Uncl. Exc.	Embt	Station	Uncl. Exc.	Embt	Station	Uncl. Exc.	Embt											
-L- RT	(cu. yd.)	(cu. yd.)	-L- RT	(cu. yd.)	(cu. yd.)	-L- LT	(cu. yd.)	(cu. yd.)											
10+55.00	0	0	35+50.00	0	1	32+50.00	51	1											
11+00.00	11	1	36+00.00	0	23	33+00.00	52	0											
11+50.00	11	0				33+50.00	57	1											
12+00.00	11	0	<b>Station</b>	<b>Uncl. Exc.</b>	<b>Embt</b>	34+00.00	47	2											
12+50.00	11	0				34+50.00	26	5											
13+00.00	11	0	<b>-L- LT</b>	<b>(cu. yd.)</b>	<b>(cu. yd.)</b>	35+00.00	12	13											
13+50.00	12	0	10+55.00	0	0	35+50.00	7	26											
14+00.00	15	0	11+00.00	9	0	36+00.00	4	48											
14+50.00	20	0	11+50.00	12	0														
15+00.00	23	0	12+00.00	11	0	<b>Station</b>	<b>Uncl. Exc.</b>	<b>Embt</b>											
15+50.00	21	0	12+50.00	12	0	<b>L</b>	<b>(cu. yd.)</b>	<b>(cu. yd.)</b>											
16+00.00	19	0	13+00.00	25	0	36+50.00	0	0											
16+50.00	18	0	13+50.00	39	0	36+95.00	6	18											
17+00.00	21	0	14+00.00	40	0														
17+50.00	21	0	14+50.00	43	0	<b>Station</b>	<b>Uncl. Exc.</b>	<b>Embt</b>											
18+00.00	23	0	15+00.00	44	0	<b>L</b>	<b>(cu. yd.)</b>	<b>(cu. yd.)</b>											
18+50.00	29	0	15+50.00	27	0	37+70.00	0	0											
19+00.00	22	0	16+00.00	13	0	38+00.00	7	24											
19+50.00	12	0	16+50.00	14	0	38+50.00	13	40											
19+67.23	4	0	17+00.00	12	0	38+50.00	37	12											
			17+50.00	11	0	39+00.00	43	3											
<b>Station</b>	<b>Uncl. Exc.</b>	<b>Embt</b>	18+00.00	11	0														
<b>-L- RT</b>	<b>(cu. yd.)</b>	<b>(cu. yd.)</b>	18+50.00	11	0														
21+24.51	0	0	19+00.00	9	0														
21+50.00	6	5	19+50.00	11	0														
22+00.00	15	0	19+67.23	3	6														
22+50.00	18	0				<b>Station</b>	<b>Uncl. Exc.</b>	<b>Embt</b>											
23+00.00	20	0				<b>-L- LT</b>	<b>(cu. yd.)</b>	<b>(cu. yd.)</b>											
23+50.00	19	0				21+24.51	0	0											
24+00.00	10	0	21+50.00	9	0	22+00.00	16	0											
24+50.00	7	0	22+50.00	11	0	22+50.00	11	0											
25+00.00	14	0	23+00.00	10	0	23+00.00	10	0											
25+50.00	17	0	23+50.00	15	0	23+50.00	15	0											
26+00.00	18	0	24+00.00	11	0	24+00.00	11	0											
26+50.00	13	0	24+50.00	26	0	24+50.00	26	0											
27+00.00	12	0	25+00.00	51	0	25+00.00	51	0											
27+50.00	13	0	25+50.00	46	0	25+50.00	46	0											
28+00.00	13	0	26+00.00	42	2	26+00.00	42	2											
28+50.00	7	0	26+50.00	55	2	26+50.00	55	2											
29+00.00	22	0	27+00.00	63	5	27+00.00	63	5											
29+50.00	36	0	27+50.00	61	5	27+50.00	61	5											
30+00.00	28	0	28+00.00	40	0	28+00.00	40	0											
30+50.00	27	0	28+50.00	8	0	28+50.00	8	0											
31+00.00	27	0	29+00.00	38	0	29+00.00	38	0											
31+50.00	14	0	29+50.00	70	0	29+50.00	70	0											
32+00.00	15	0	30+00.00	48	0	30+00.00	48	0											
32+50.00	31	0	30+50.00	30	2	30+50.00	30	2											
33+00.00	26	0	31+00.00	34	3	31+00.00	34	3											
33+50.00	20	0	31+50.00	50	1	31+50.00	50	1											
34+00.00	21	0	32+00.00	56	1	32+00.00	56	1											
34+50.00	23	5																	
35+00.00	12	5																	

INDEX OF SHEETS	
-L-	X-1 THRU X-14

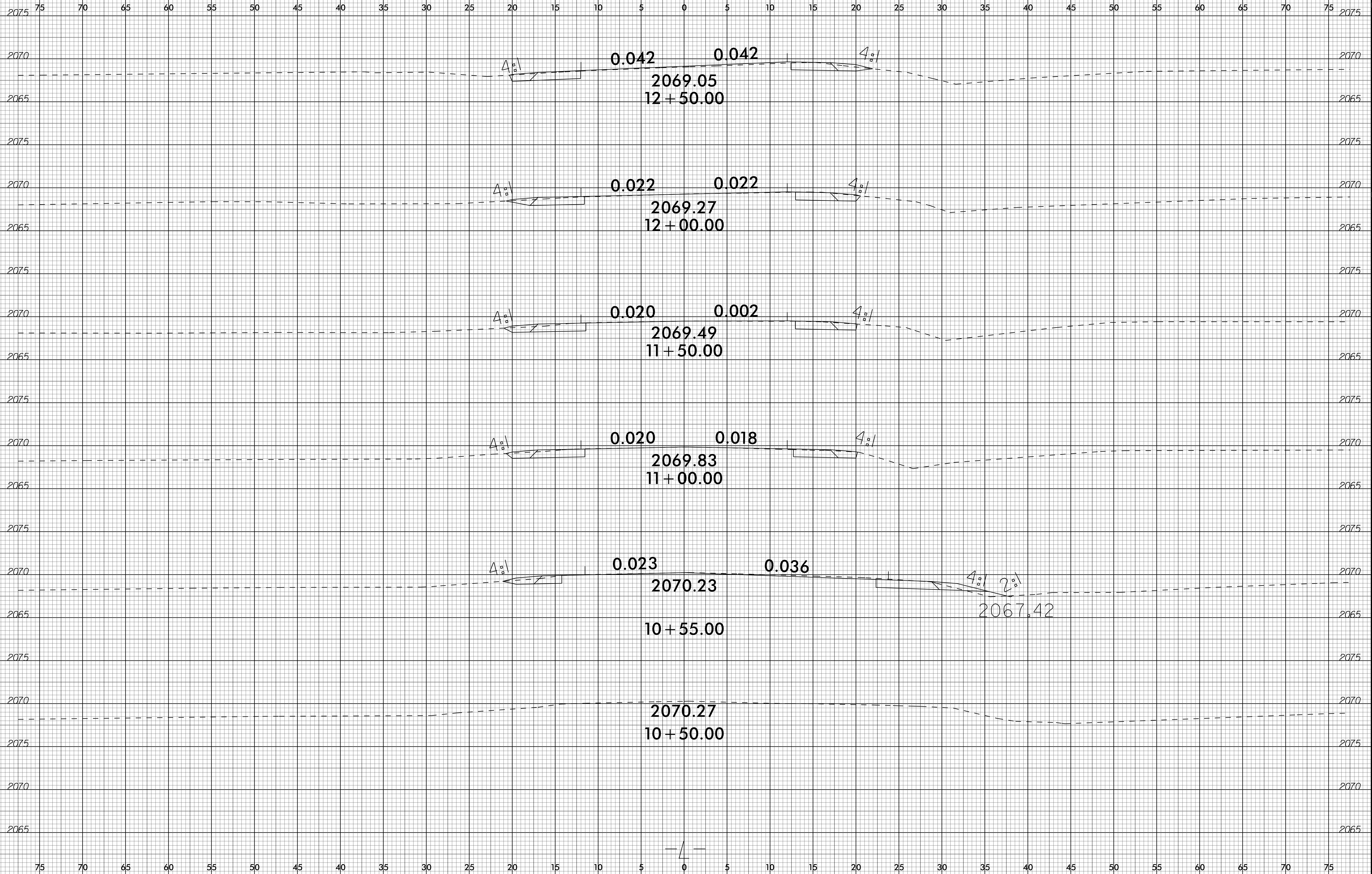

6/23/16



PROJ. REFERENCE NO.  
R-5207C

SHEET NO.  
X-2

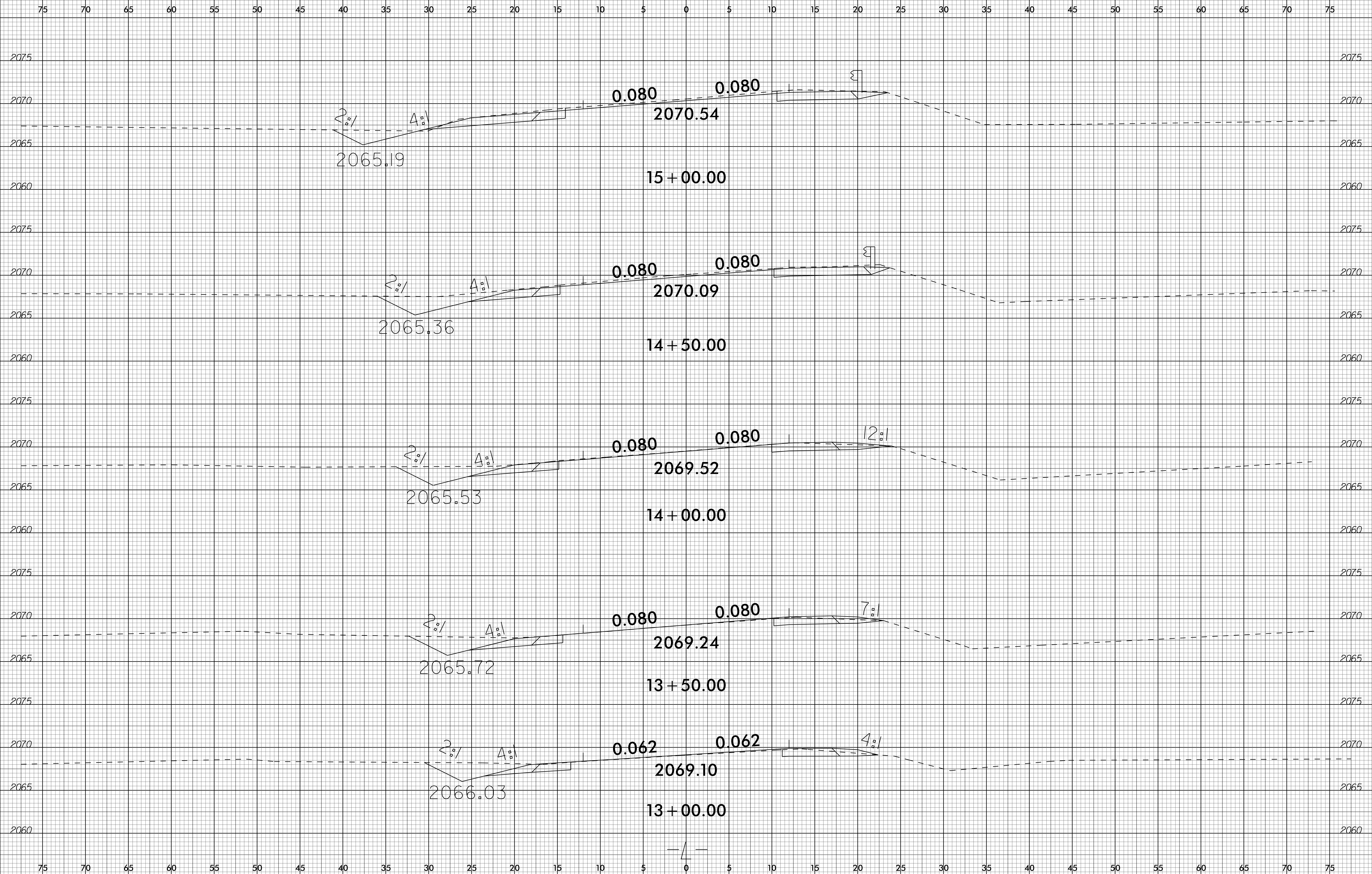

I:\JAN-2016 0732  
5:14051494X\6649207C\_Rdy\_xpl.dgn  
6/23/16 10:53:58

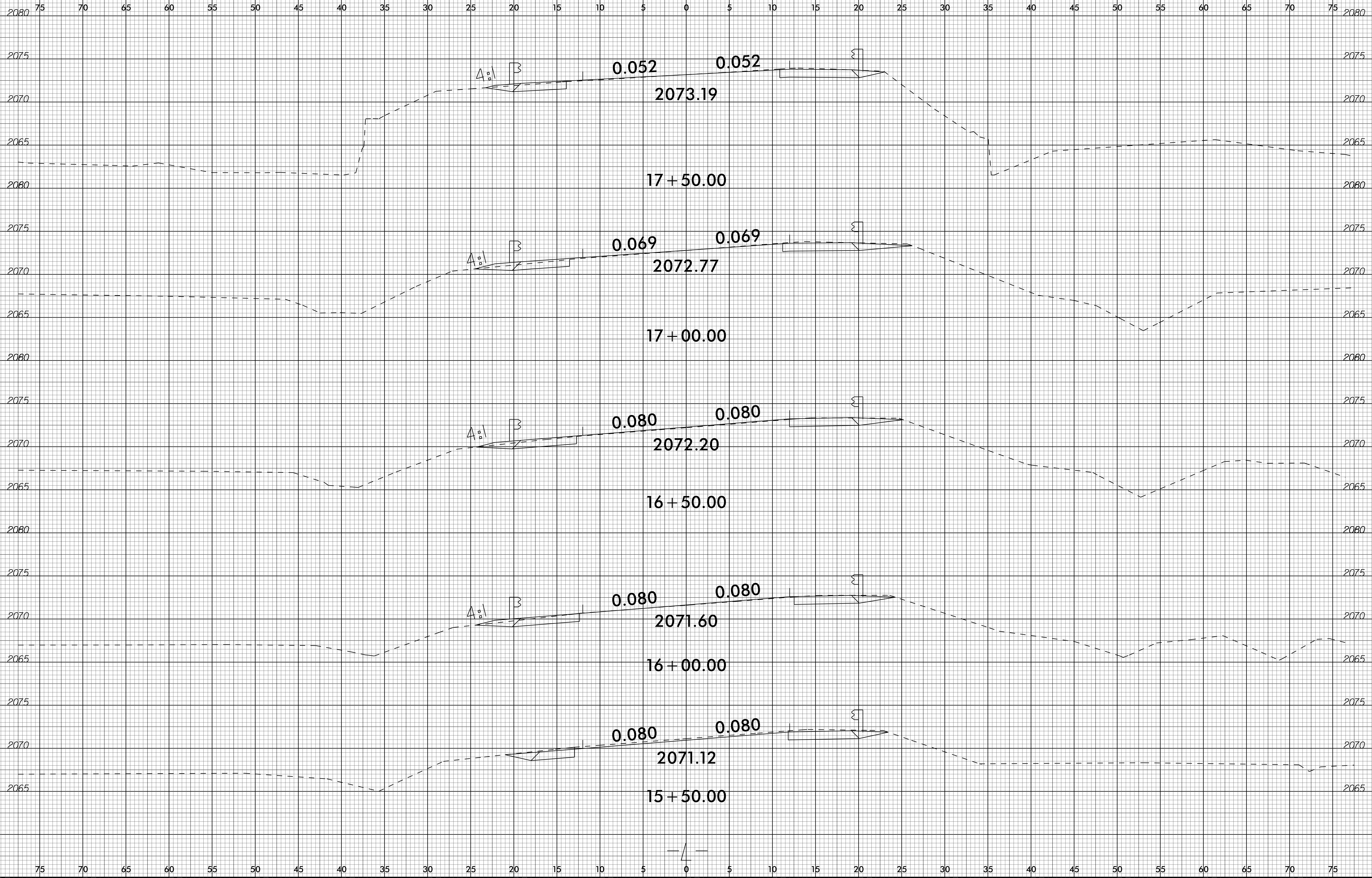

6/23/16



PROJ. REFERENCE NO.  
R-5207C

SHEET NO.  
X-4

75 70 65 60 55 50 45 40 35 30 25 20 15 10 5 0 5 10 15 20 25 30 35 40 45 50 55 60 65 70 75

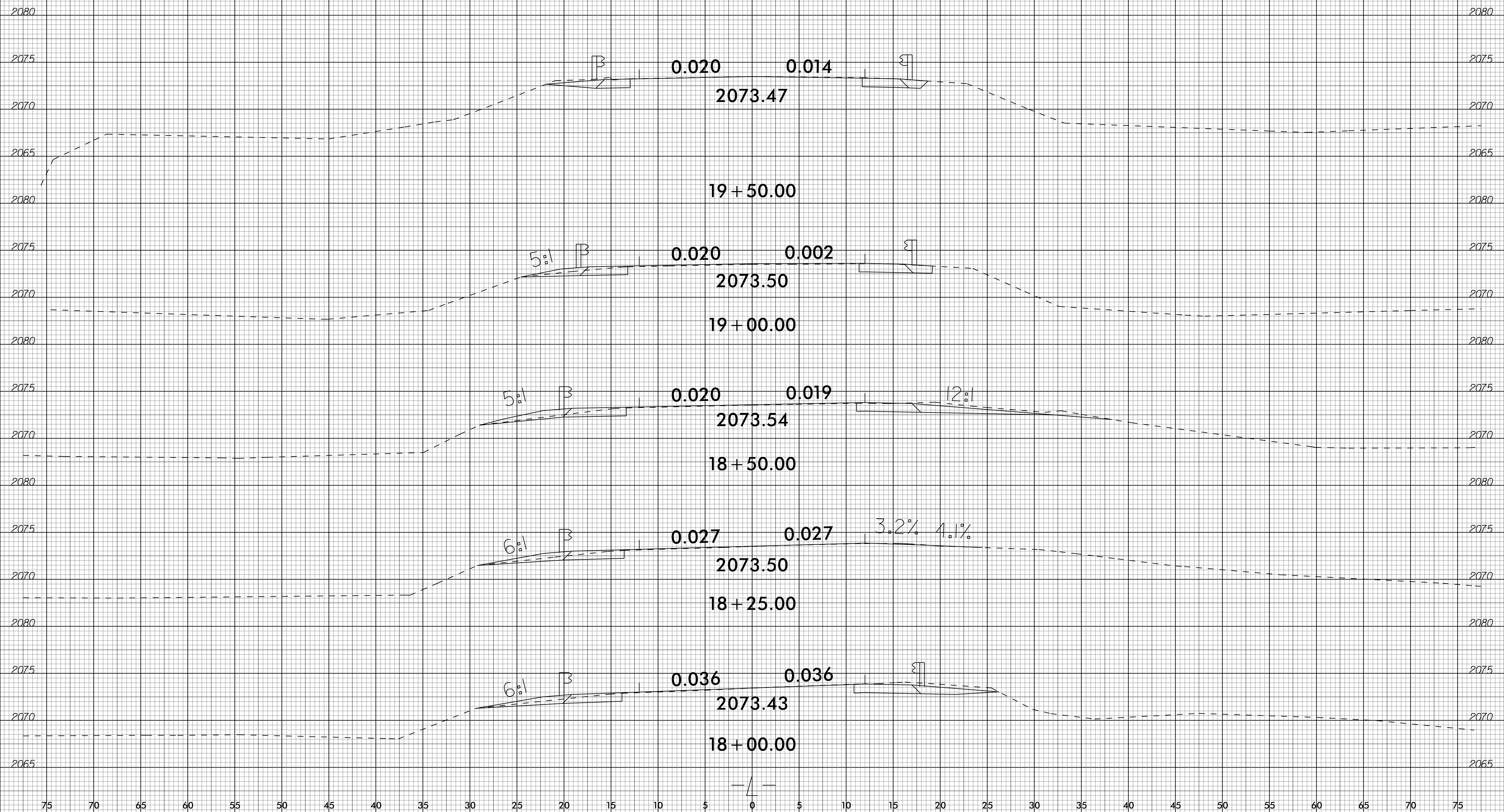

T:\JAN-2016 13:00 R-5207C\_Rdy\_xpl.dgn  
6/23/16 11:58:58

75 70 65 60 55 50 45 40 35 30 25 20 15 10 5 0 5 10 15 20 25 30 35 40 45 50 55 60 65 70 75

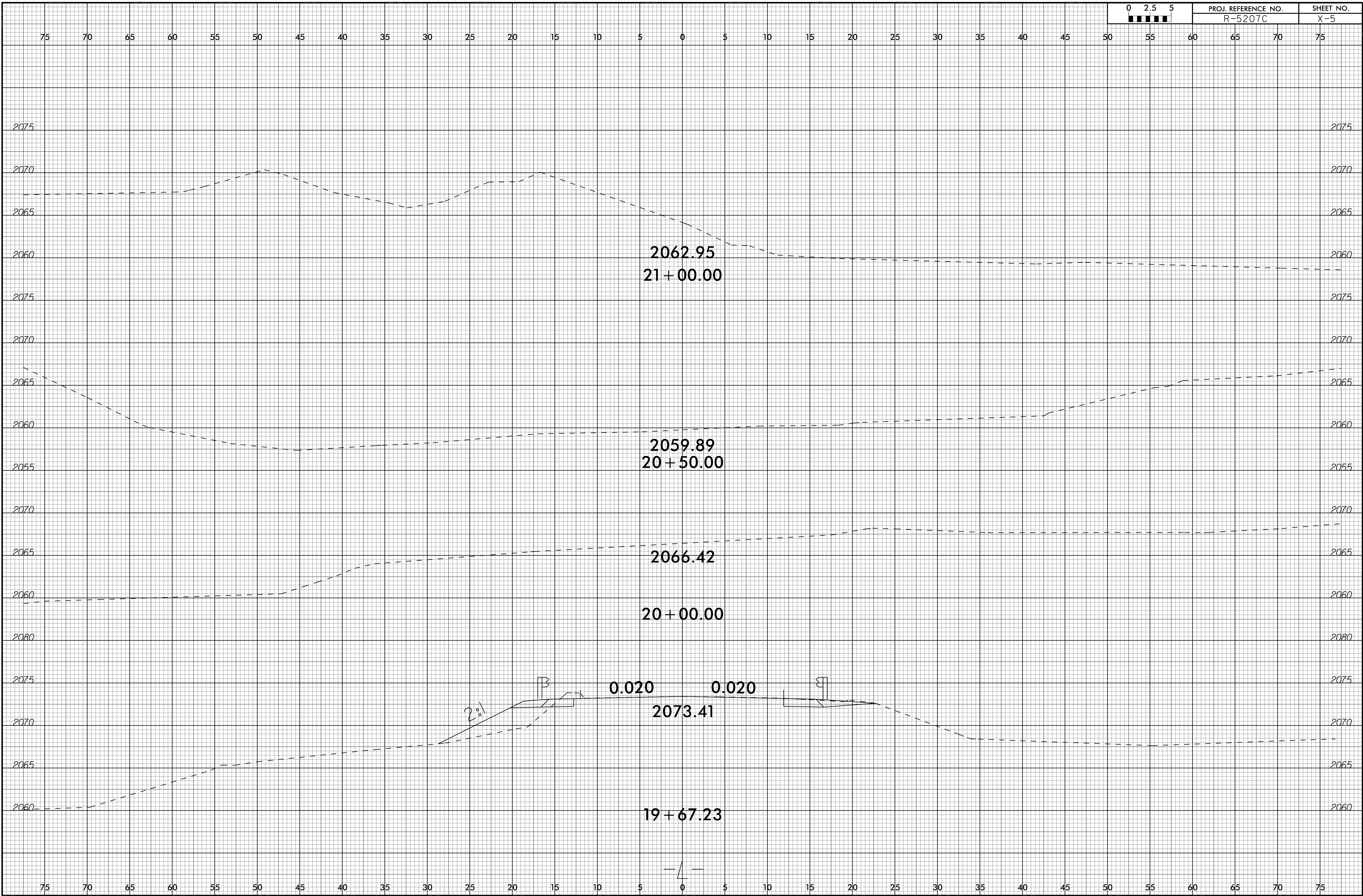

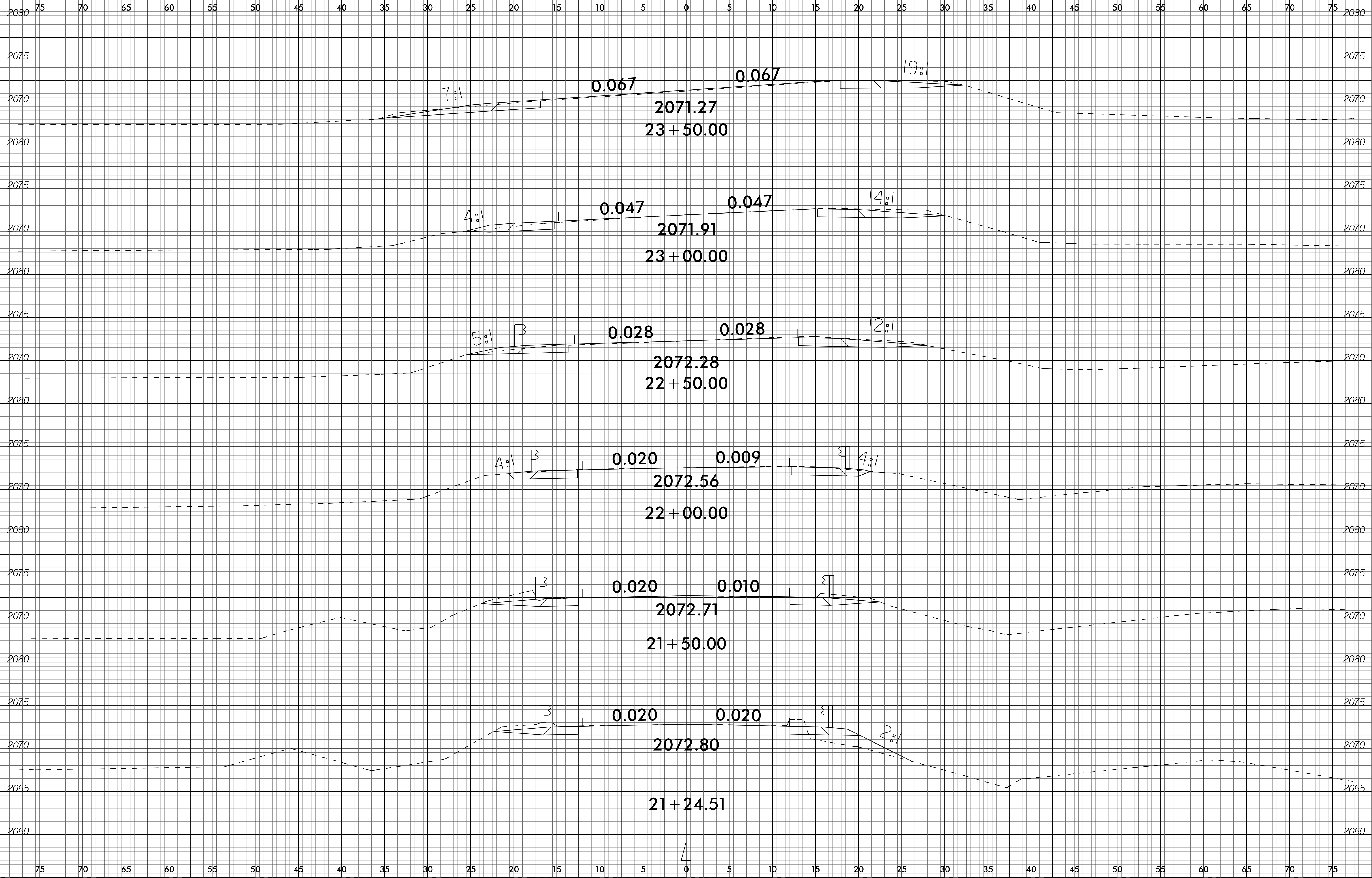



6/23/16



PROJ. REFERENCE NO.  
R-5207C

SHEET NO.  
X-7

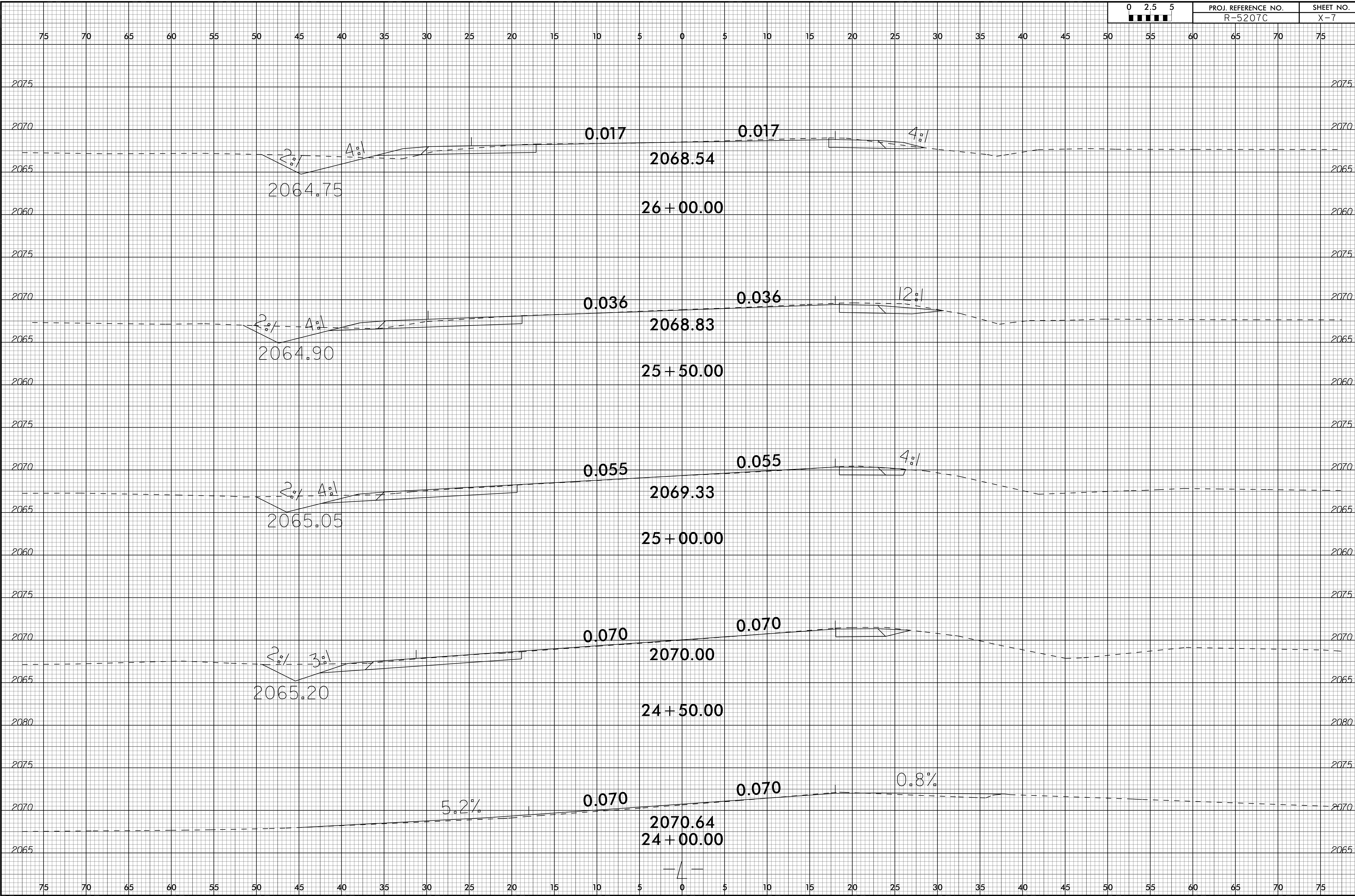

I:\JAN-2016 07:40  
S:\PROJECTS\X-7\REF5207C\_Rdy\_xpl.dgn  
6/23/16 10:53:38

6/23/16



PROJ. REFERENCE NO.	SHEET NO.
R-5207C	X-8

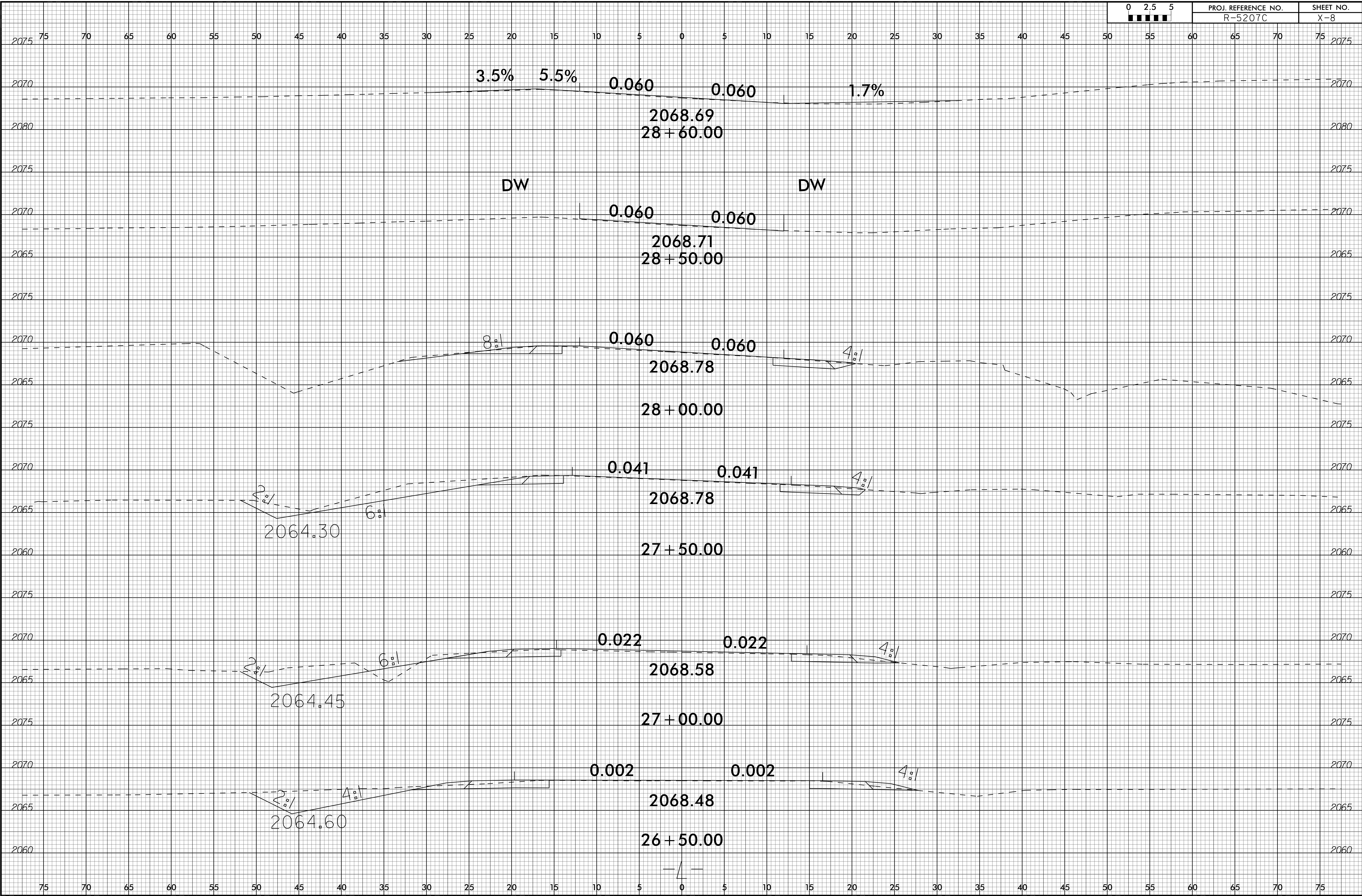

I:\JAN-2016\0743\6-PROFILES\X-8-R-5207C-Rdy\_xpl.dgn

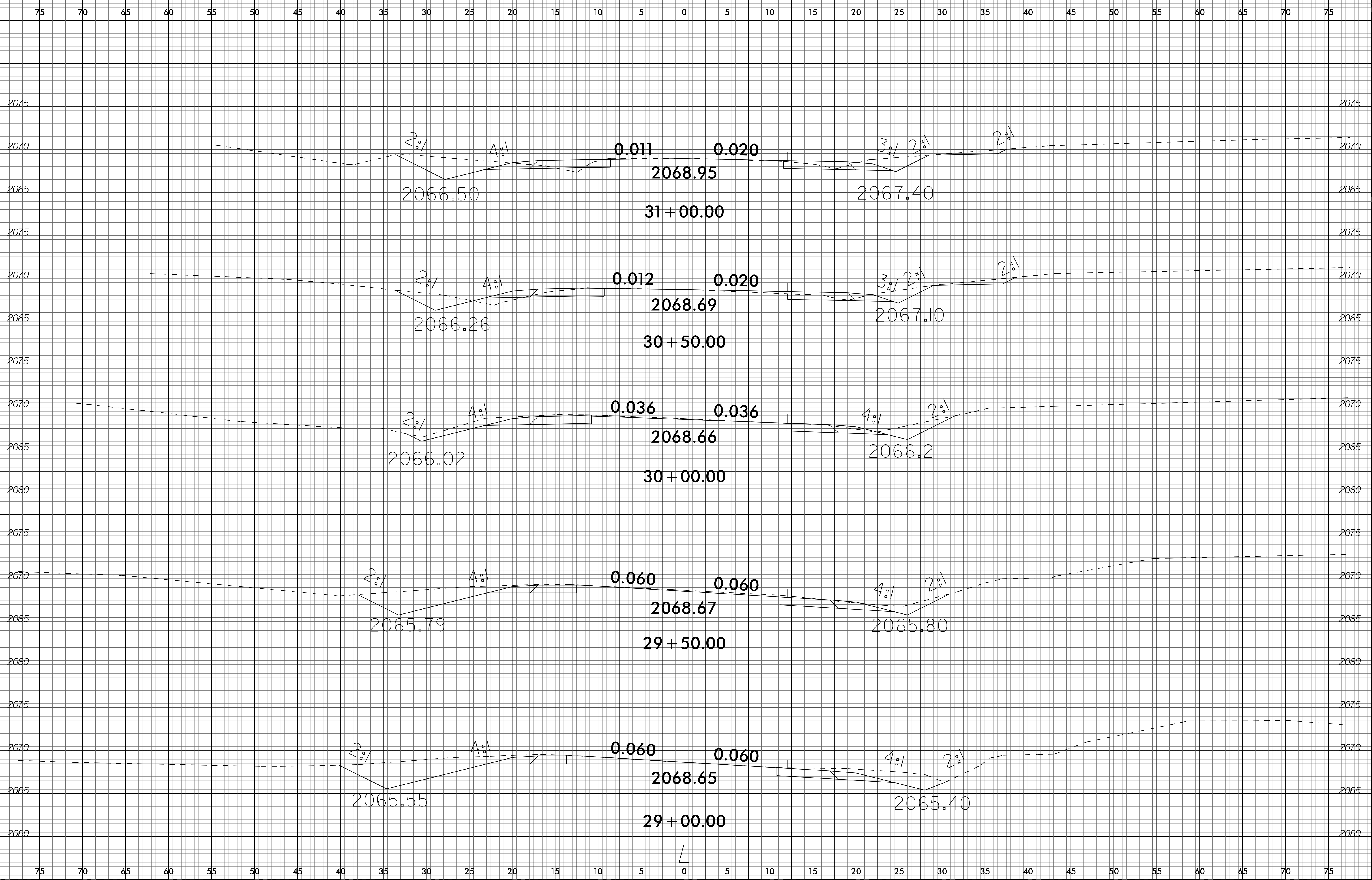

6/23/16

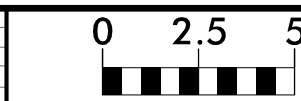

PROJ. REFERENCE NO.  
R-5207C

SHEET NO.  
X-10

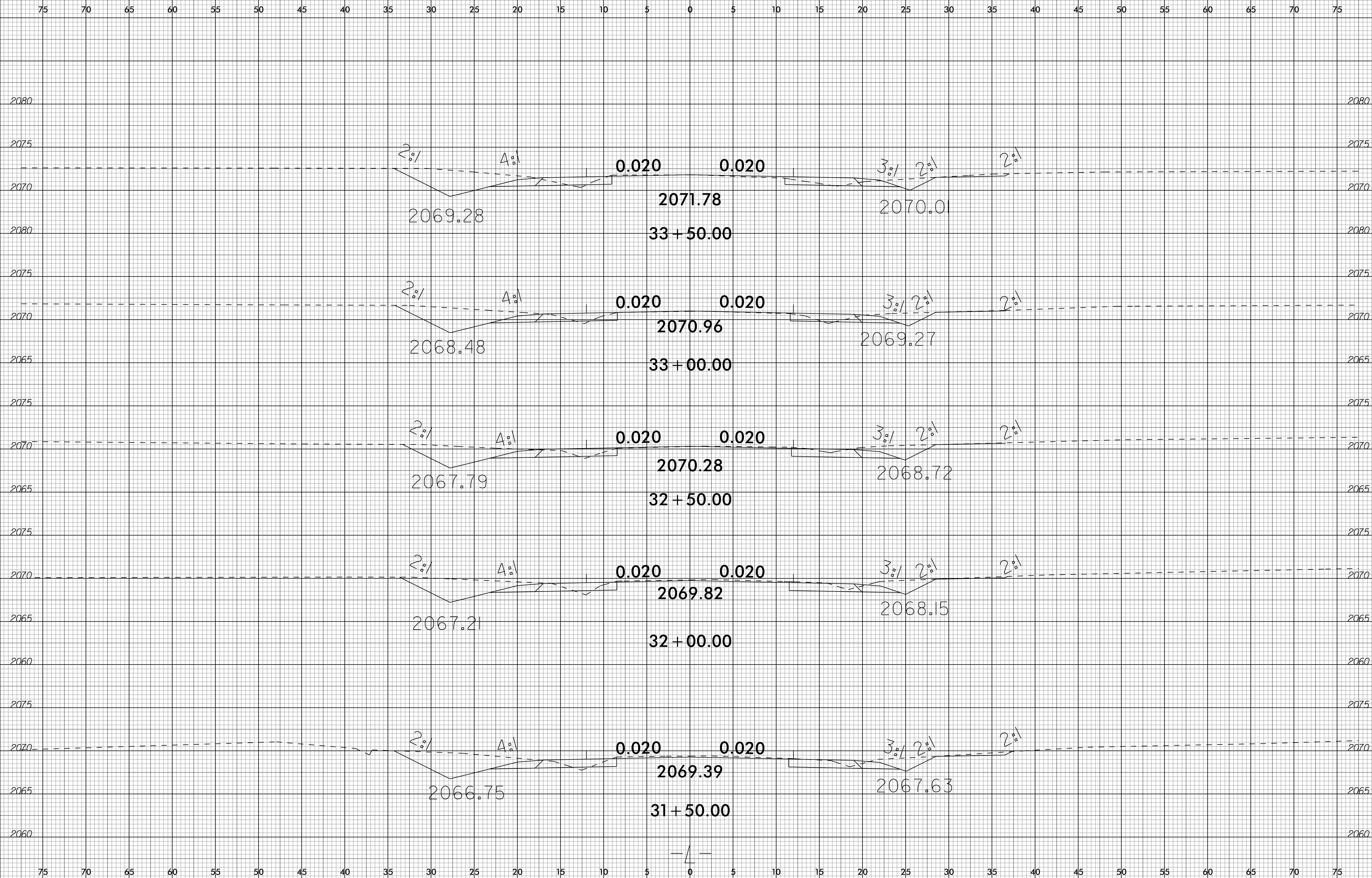

01-NOV-2017 13:10 P:\05207C.Rdy\_xpl.dgn

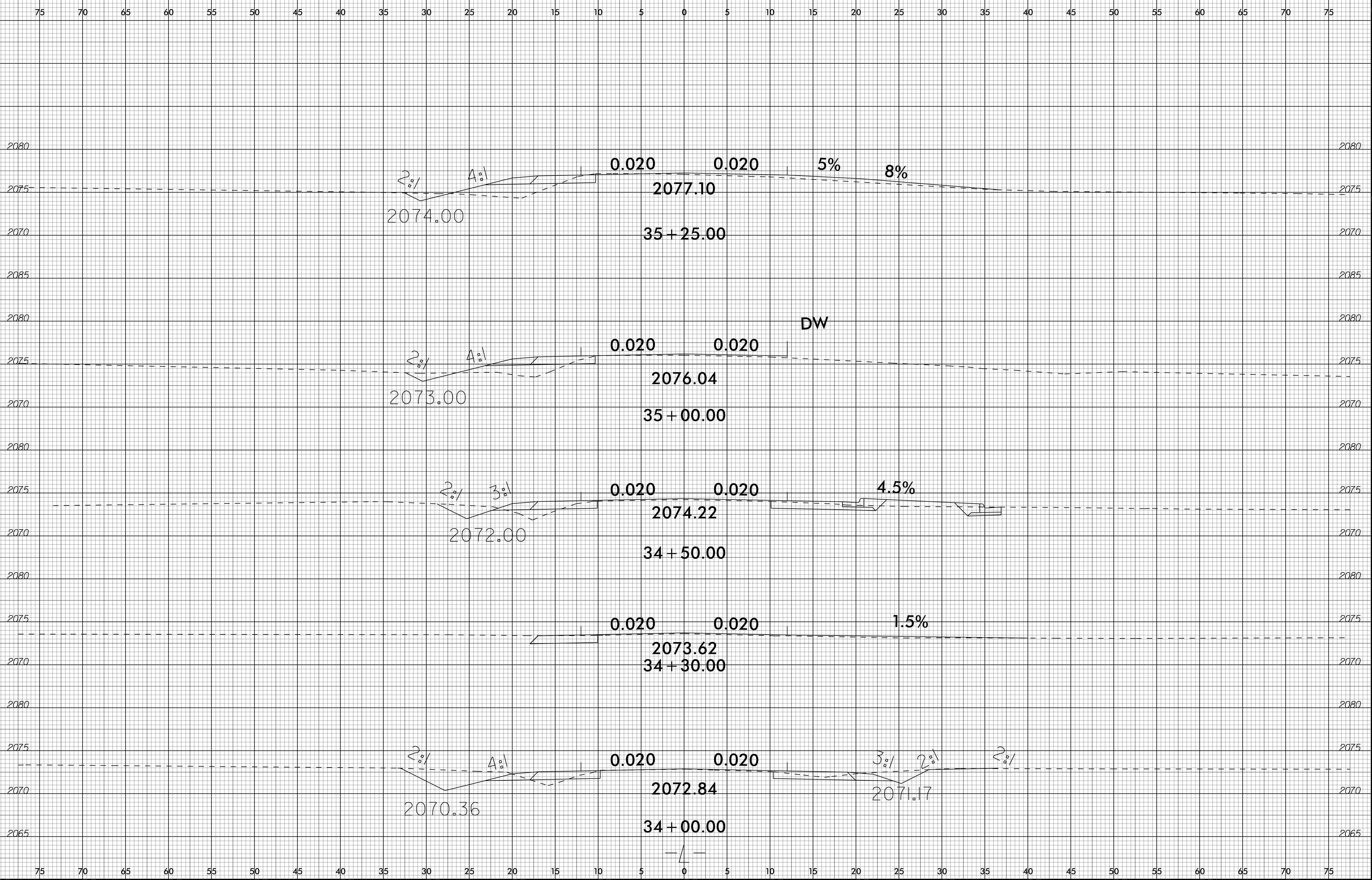

6/23/16



PROJ. REFERENCE NO.  
R-5207C

SHEET NO.  
X-12

75 70 65 60 55 50 45 40 35 30 25 20 15 10 5 0 5 10 15 20 25 30 35 40 45 50 55 60 65 70 75

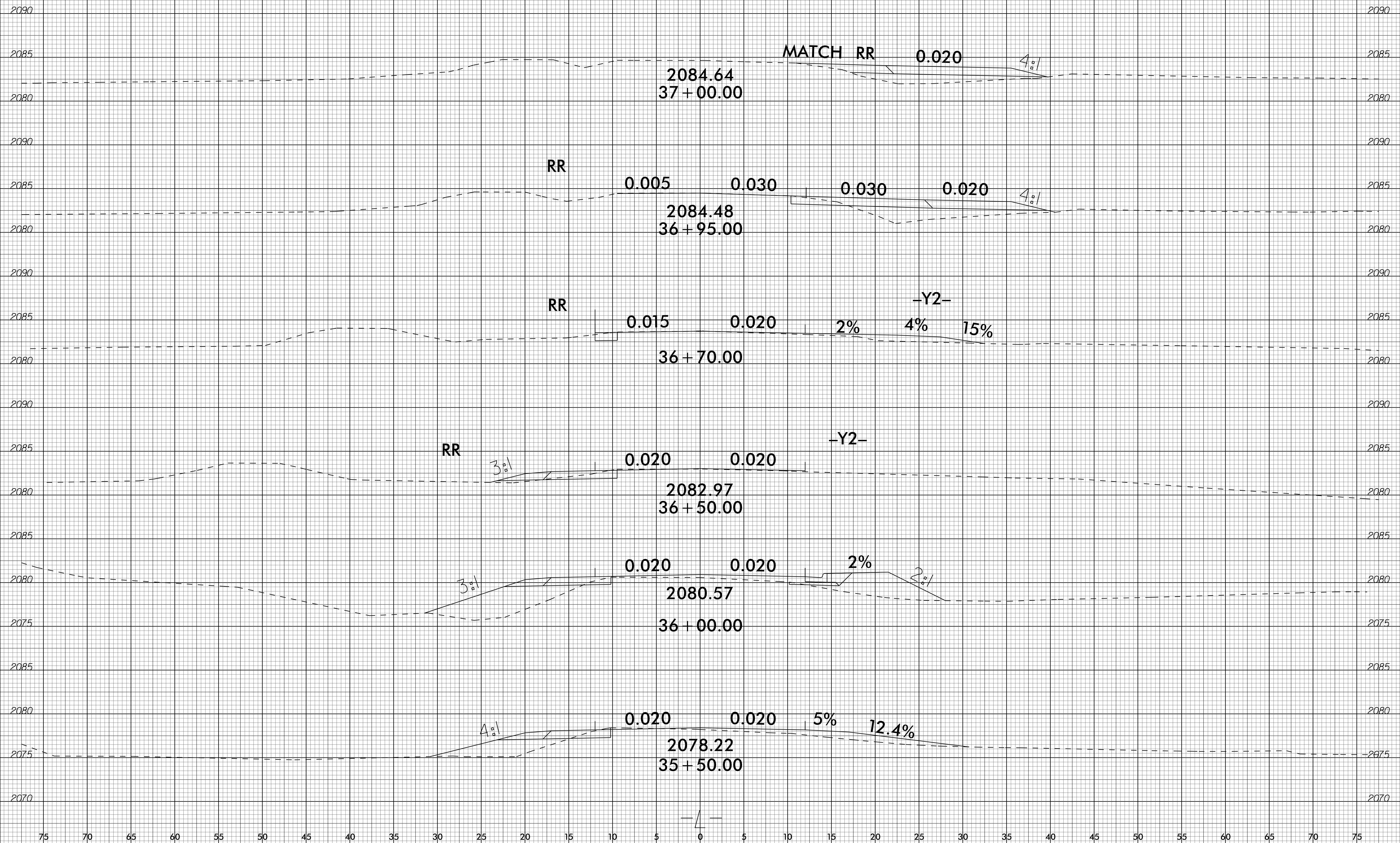

75 70 65 60 55 50 45 40 35 30 25 20 15 10 5 0 5 10 15 20 25 30 35 40 45 50 55 60 65 70 75

I:\JAN-2016 07:46  
S:\PROJECTS\X-12\REF5207C\_Rdy\_xpl.dgn  
S:\PROJECTS\X-12\REF5207C\_Rdy\_xpl.dgn

6/23/16



PROJ. REFERENCE NO.  
R-5207C

SHEET NO.  
X-13

75 70 65 60 55 50 45 40 35 30 25 20 15 10 5 0 5 10 15 20 25 30 35 40 45 50 55 60 65 70 75

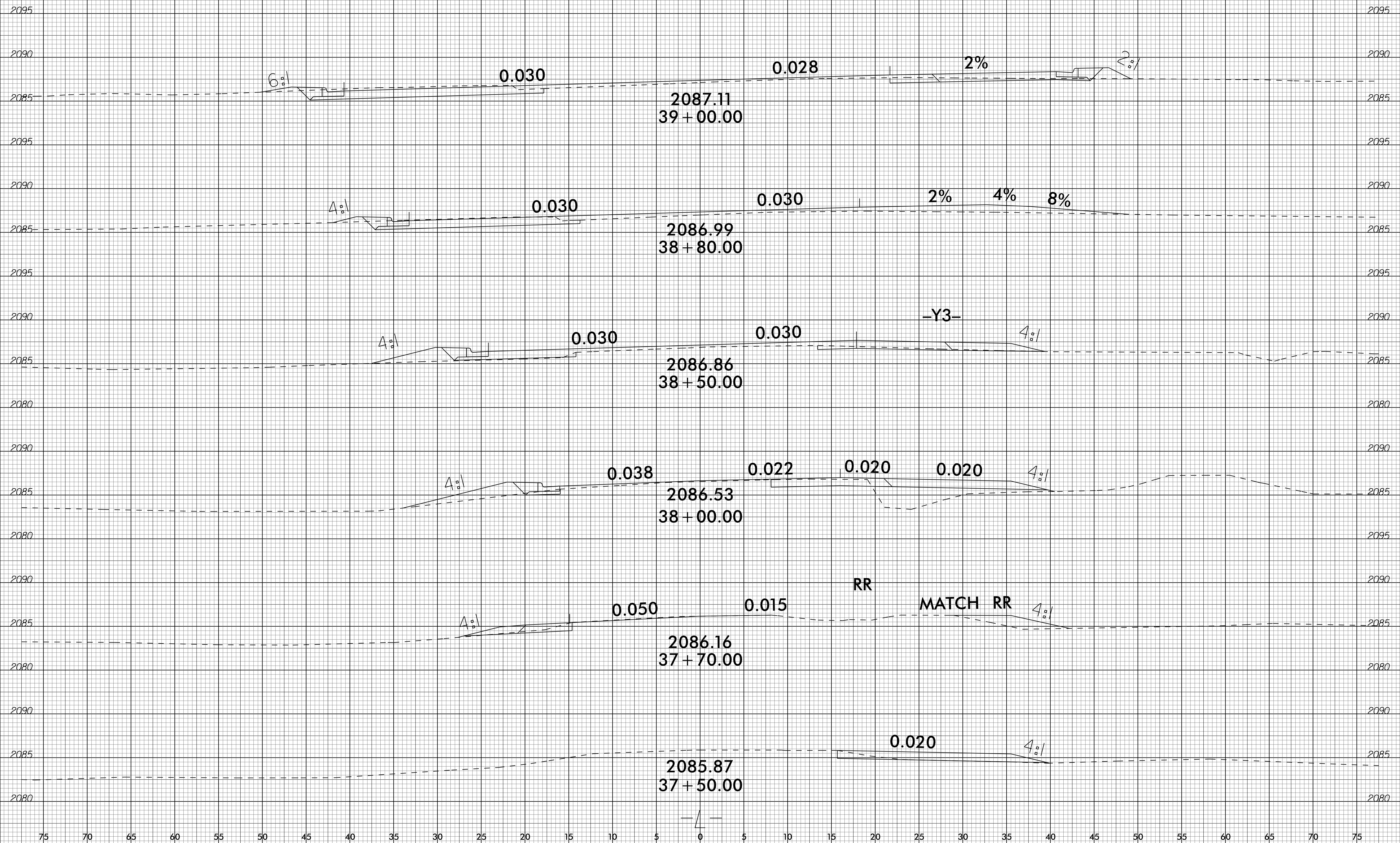

75 70 65 60 55 50 45 40 35 30 25 20 15 10 5 0 5 10 15 20 25 30 35 40 45 50 55 60 65 70 75

27-OCT-2017 13:51 R-5207C\_Rdy\_xpl.dgn

75 70 65 60 55 50 45 40 35 30 25 20 15 10 5 0 5 10 15 20 25 30 35 40 45 50 55 60 65 70 75

